



# CAPITAL

— OF THANE —





## What's common between London, Paris and Delhi?

They are the Capitals that represent the best a region has to offer in terms of lifestyle, opportunities and connectivity. It's time Thane got its own capital too.

---

Thane is on the brink of a transformative leap. Now, more than ever, the city is ready to establish its own capital, a nucleus of power, growth, opportunity, and prosperity.



A Name at the Forefront of  
**THANE'S EVOLUTION**

And the Happiness of Thousands of Families.

---

As Thane evolves into its role as a centre of opportunity and prosperity, Vihang Group's developments have been integral in this shift.

**Since 1989**, Vihang Group has been at the forefront of Thane's transformation, playing a pivotal role as a leading developer in the city. Our impressive portfolio features projects like Vihang Valley, Vihang Hills, Vihang Vermont, Vihang Nova, Vihang Woods, and Vihang Marina.

Our focus has always been on turning the concept of aspirational luxury into a living reality for Indian families, aligning perfectly with Thane's journey towards becoming a vibrant centre of life.

**34**

Successful  
Years

**20**

Lakh sq. ft.  
Developed

**30**

Lakh sq. ft.  
Developing

**20+**

Projects  
Developed

**3500+**

Flats in  
Progress

**2000+**

Happy  
Families

— A NEW —  
**CENTRE  
OF LIFE**



# GROWTH. LIFE. POWER.

A Location that Puts You in the Middle of It All.

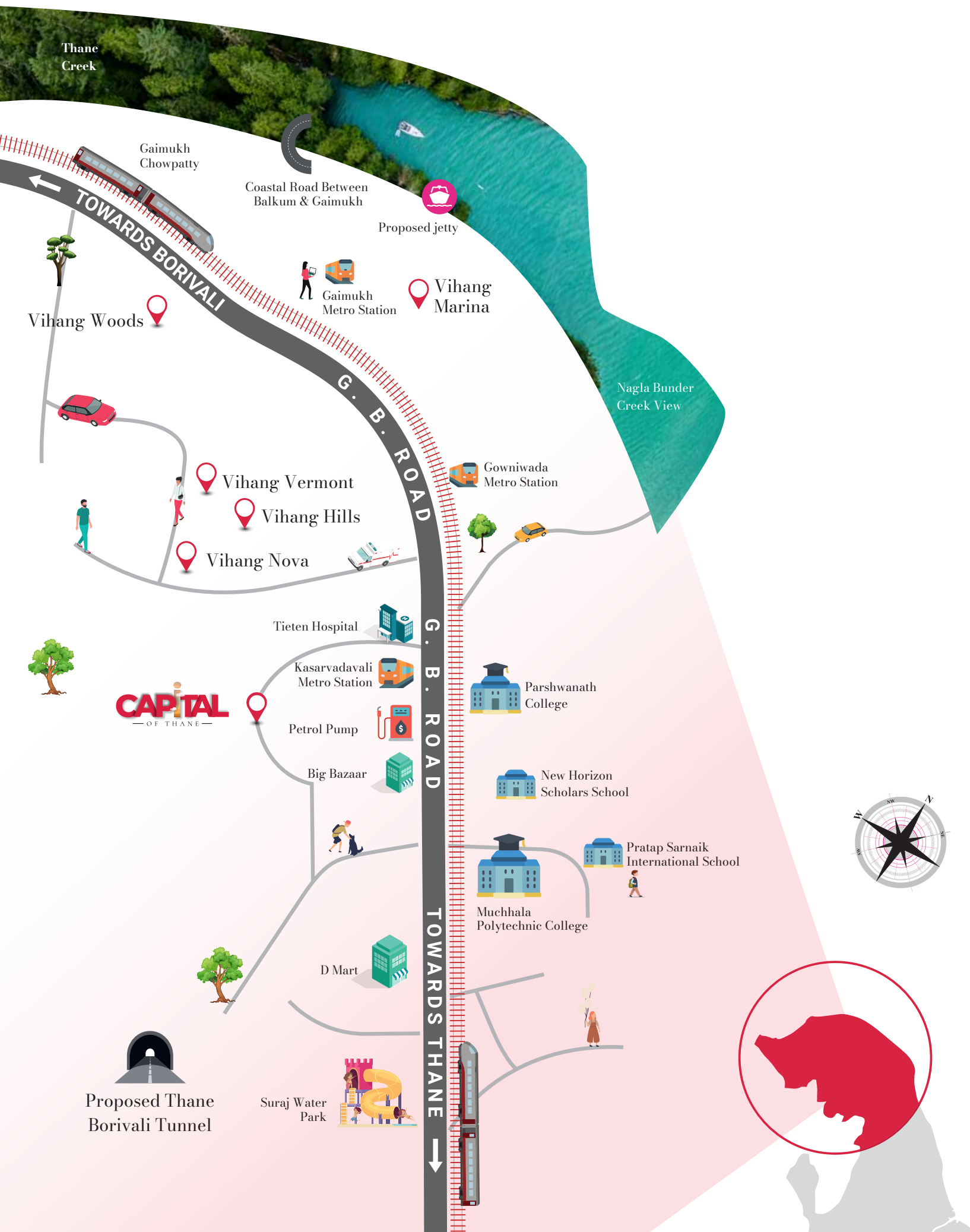

## The Commercial Capital

- Banks - 5 min
- G Corp Tech Park - 5 min
- MBC Park - 5 min
- Thane One Corporate Business Park - 12 min
- Orion Business Park - 12 min

## Infrastructural Capital

- Oscar Multispeciality Hospital - 2 min
- Tieten Hospital - 2 min
- Kasarvadavali Metro Station - 3 min
- Gowniwada Metro Station - 5 min
- Gaimukh Metro Station - 7 min
- Currae Hospital - 12 min
- Western Express Highway - 15 min
- Eastern Express Highway - 15 min

## Lifestyle Capital

- Big Bazaar - 5 min
- McDonald's - 6 min
- D-mart - 6 min
- R Mall - 12 min
- Vihang's Inn - 12 min
- Tikuji-ni-wadi - 13 min
- Viviana Mall - 16 min
- Vihang's Palm Club - 20 min

## Natural Capital

- Heart Shape Lake - 5 min
- Ovalekar Wadi Butterfly Garden - 5 min
- TMC Biodiversity - 5 min
- Gaimukh Chowpatty - 10 min
- Sanjay Gandhi National Park - 12 min
- Upvan Lake - 12 min

## Education Capital

- Seven Square Academy - Right Opposite
- Eva World School - 2 min
- Holy Family High School - 3 min
- DG International School - 5 min
- Ryan International School - 5 min
- Pratap Sarnaik International School - 5 min
- Cambridge International Preschool - 7 min
- S. G. English School - 7 min
- New Horizon's Scholar School - 7 min
- Euro School - 7 min
- New Horizon Institute of Technology - 7 min
- Orchid's International School - 12 min

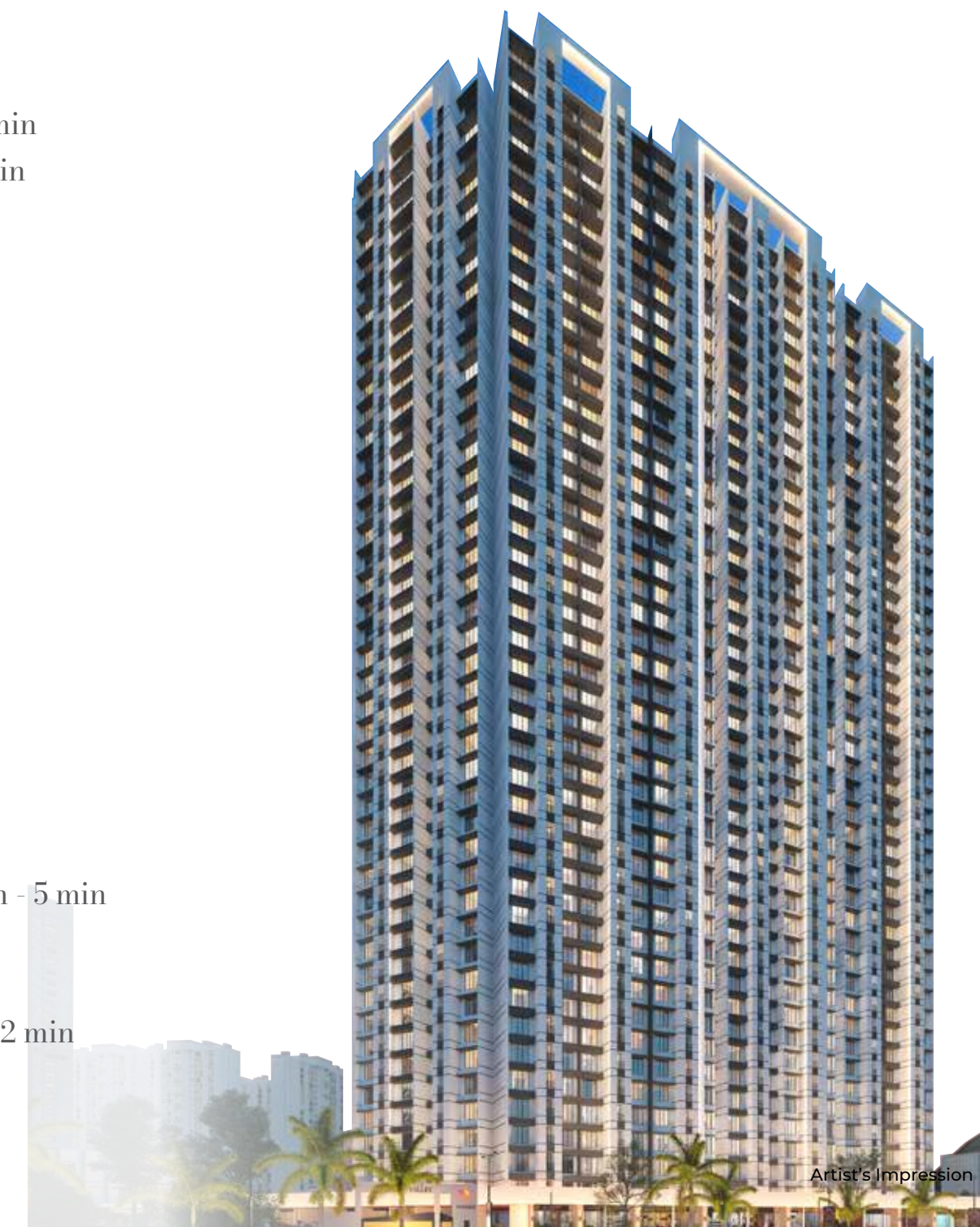

Artist's Impression

## PROPOSED

---



Borivali Thane twin tunnel  
a travel time reduced to 15 mins



Hi-speed Thane road- 6 lane road  
from Mulund to Gaimukh, Thane will be  
reducing travel time to 10 mins



Kolshet-South Mumbai-Vasai waterway -  
first Intracity water service



Central park road linking Kolshet &  
Bhiwandi - will cover 17 kms in 10 mins



Underground railway line connecting  
CST-Thane - 21 mins travel time



2 new bridges over Thane Creek  
speeding up Mumbai-Nashik travel

## UPCOMING

---



**Mumbai Metro Line 4 -**  
*an elevated metro line from  
Wadala to Thane*



**Mumbai Metro Line 5 -**  
*seamless connectivity from  
Thane to Kalyan via Bhiwandi*



A city that delivers more than what's expected in a neighbourhood that scripts the new era of lifestyle in the city, is a natural home to a real estate revolution.

---

Presenting a lifestyle destination situated in **Kasarvadavali**, the most dynamic neighborhood of Thane, set to push forward the city's unbreakable will and boundless potential.

# CAPITAL

— OF THANE —

- Premium 1 and 2 BHK homes
- State-of-the-art elevation
- Premium lifestyle amenities
- Handpicked experiences exclusive to each tower
- Located in the most thriving neighborhood of Thane
- Easy connectivity to Central & Western Suburbs of Mumbai
- A clubhouse for all residents
- Access a world of conveniences right in your vicinity



For Every Reason You'd Want To Step Out,  
**Here's A Clubhouse That'll Make  
You Eager To Stay Back In.**

---

**A 25,000 SQ. FT. GRAND  
MULTI-STOREY CLUBHOUSE  
AT THE CAPITAL**



# Everything You Need for a Switch from the Mundane on the Ground Floor.

- Indoor Games Area
- Two Squash Courts
- Badminton Court
- Crèche for Kids
- Temple
- Landscape Area
- Coffee Shop



Type your text



Representative images.

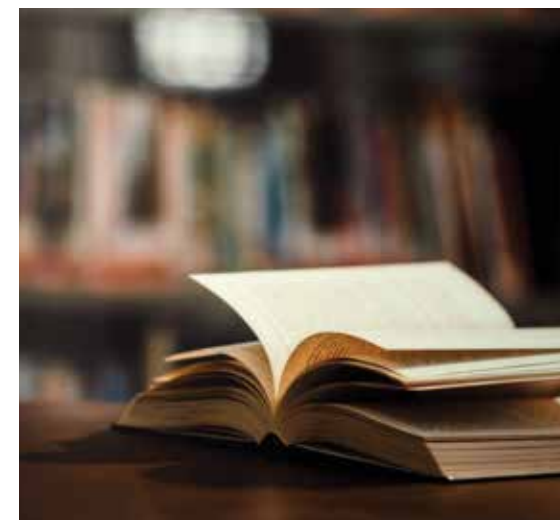

## Finest Lifestyle and Community Upgrades on the First Floor.

- Gymnasium
- Yoga Room & Aerobics
- Library
- Mini Theater
- Swimming pool

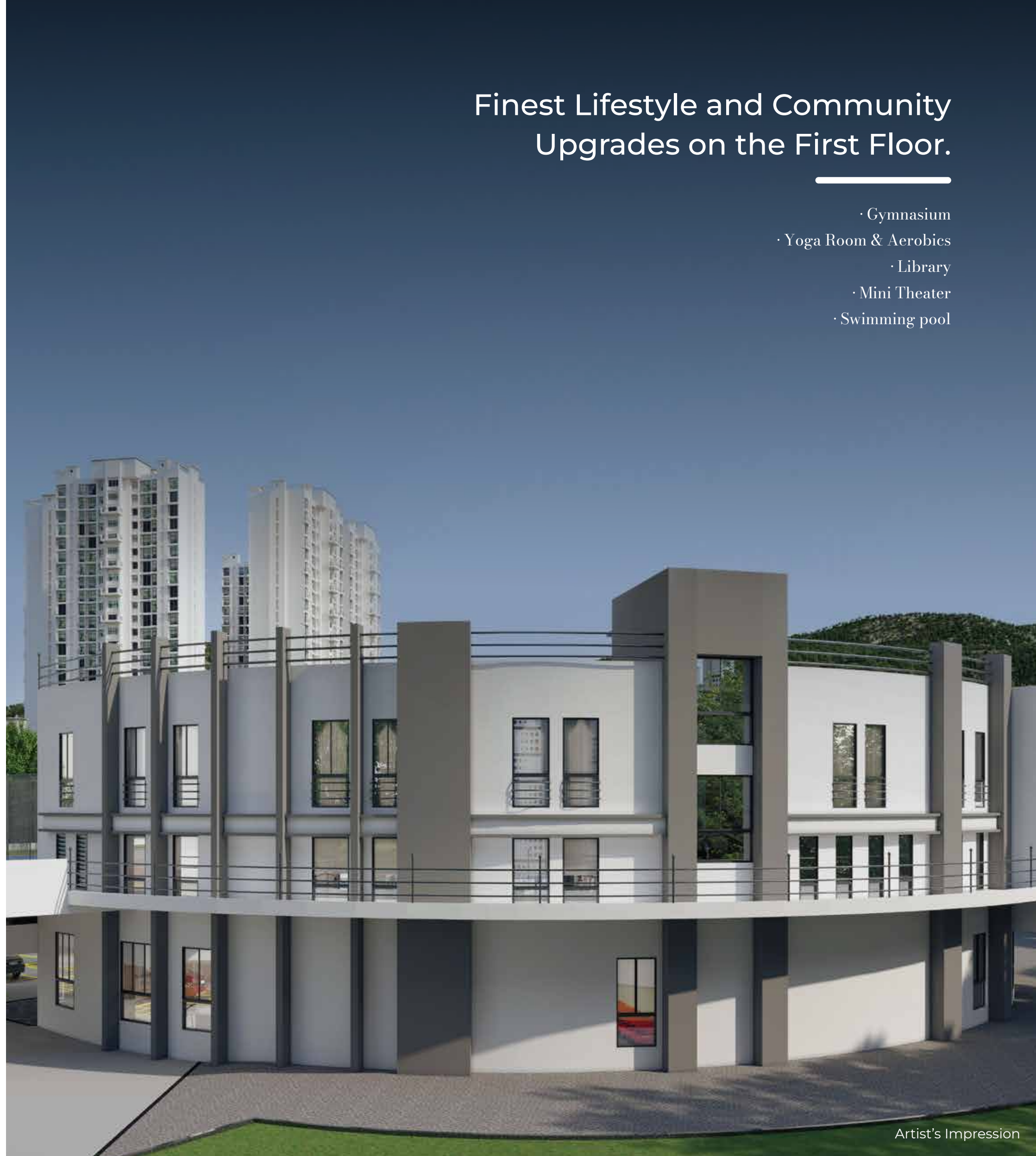

Behold the second club exclusive to the towers at the Capital - The SkyClub.

- Gymnasium
- Indoor Game Room

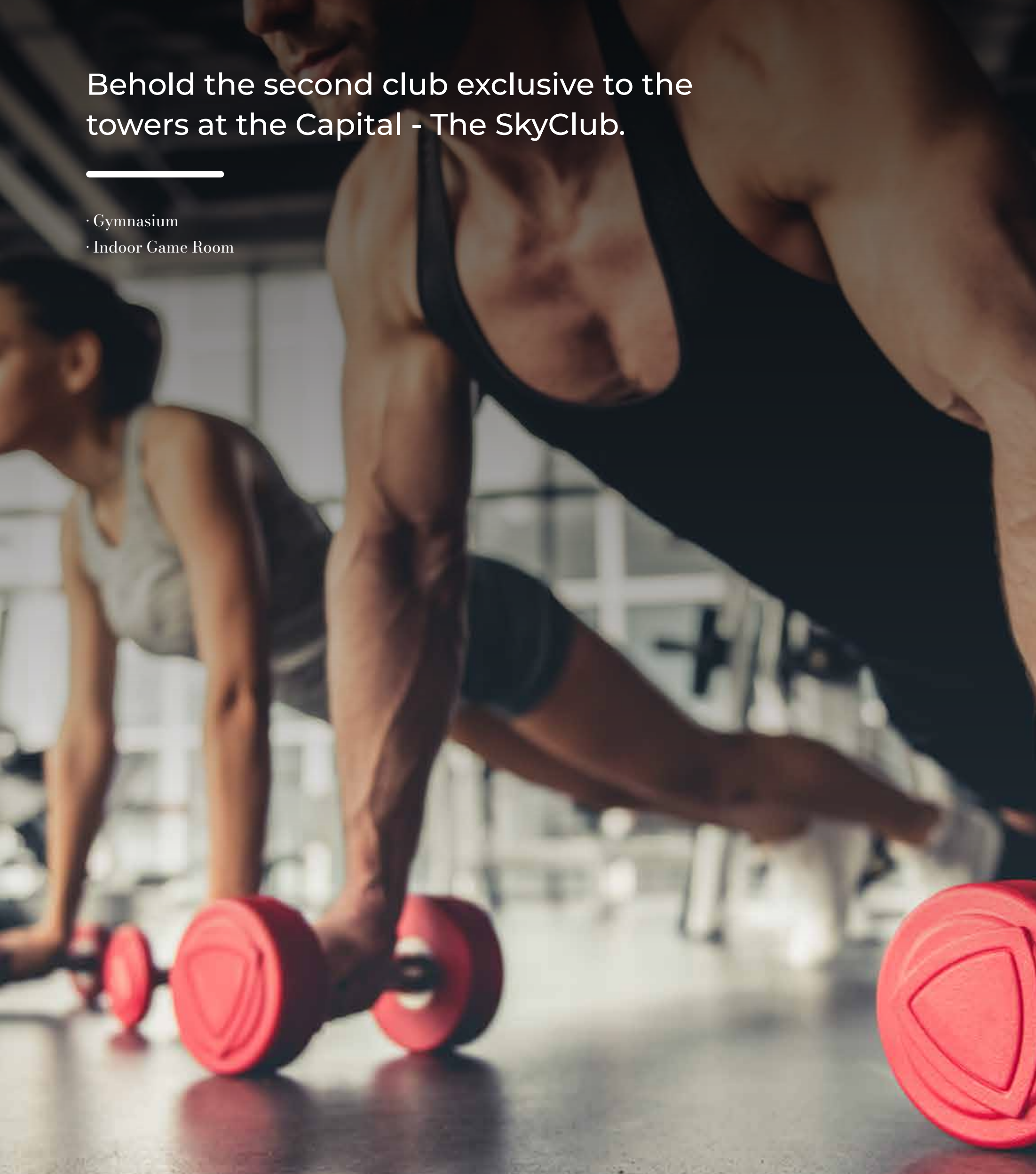

Representative images.

# MASTER LAYOUT



## The Finest Finishes, Fitments, Planned for You in The Capital.



**Vitrified** tiles of reputed brands



Kitchen **granite counter** with SS sink



Aluminum powder coated **sliding windows**



**Lifts** of reputed brand



Switches and wiring of **reputed brand**



Fire fighting **system enabled**



Elegantly design **entrance lobby**



Fire-rated **main doors**



Bathroom fittings of **reputed brands**



Rainwater **recharge pit**



**CCTV** surveillance in common areas



Power backup in **common area**



# CAPITAL

— OF THANE —

CORPORATE OFFICE: 12TH FLOOR, DEV CORPORA, CADBURY JUNCTION,  
EASTERN EXPRESS HIGHWAY, KHOPAT, THANE (W) 400601.

SALES EXPERIENCE CENTRE: VIHANG VALLEY PHASE 4, KASARVADAVALI,  
GHODBUNDER ROAD, THANE (W), 400615



MAHA RERA NO. P51700034145  
and P51700034754

Disclaimer: This brochure does not constitute an offer and/or acceptance and/or contract and/or agreement and/or transaction and/or any intention thereof and/or a disclosure under any statute of any nature whatsoever. The layout plan, the orientation of buildings/towers/wings/structures, the common areas, facilities and amenities, the fixtures, fittings, soft furnishing/furniture, gadgets, technology, information, pictures, images and visuals, drawings, specifications, sketches and other details herein are merely a creative imagination and an Architect's impression and are only indicative. The developer reserves the right to change any or all of these in the interest of the development as permissible under law. These should not be construed in any manner as disclosures under the provisions of the Real Estate (Regulation and Development) Act, 2016 and the Rules thereunder and/or applicable law, and the relevant applicable disclosures shall be made at an appropriate time. All dimensions mentioned in this brochure may vary/differ due to construction exigencies. Actual product may vary/differ from what is indicated herein. Further, dimensions mentioned on the floor plans are as per the plans approved by the Municipal Corporation of Thane and the same are subject to construction exigencies. The photographs contained herein may be stock/standard photography used for the purpose and may have been taken at a location other than the project site and are used to indicate a conceptual lifestyle. No representation or warranty is made or intended as to the accuracy or completeness of information herein or as to its suitability or adequacy for any purpose.