

Unleash the Perfect Atmosphere: Discover the Secrets of Controlling Your Fog Machine's Output!

Fog machines have become an essential tool in creating the perfect atmosphere for various events, from theatrical performances to memorable parties and even stunning photography sessions. They add a mysterious and enchanting element that can transform any setting into something extraordinary. However, not all fog machines are created equal, and one of the most critical features to consider when purchasing one is the ability to control the fog output. This control is especially important for achieving the desired ambiance, whether you aim for a wispy haze or a dense fog. In this article, we'll explore the importance of [speed control options](#) in fog machines, helping you make an informed decision for your next purchase.

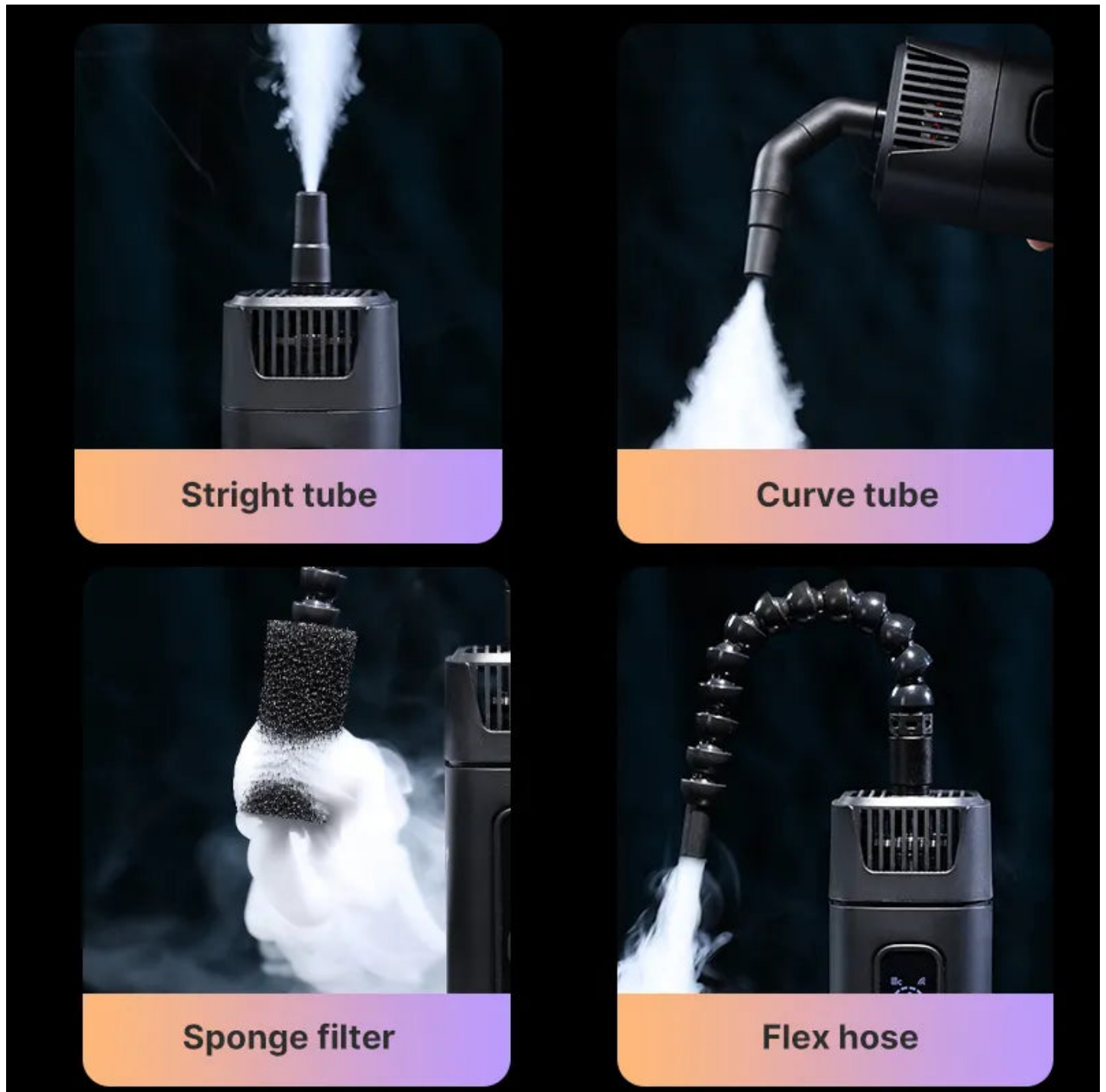

Understanding Fog Machines and Their Functionality

Fog machines work by vaporizing a specially formulated fluid, creating fog that can enhance lighting effects and create a desired mood. There are primarily two types of fog machines: those that use water-based fog fluid and those that utilize oil-based fluid. Water-based fog machines are more common and are often preferred for indoor events due to their safety and ease of use. The density of the fog plays a significant role in how it interacts with light and fills a space. A thicker fog can create a dramatic effect, while a lighter fog can produce a more subtle ambiance. Understanding the functionality of fog machines allows users to tailor their atmospheric needs effectively.

Importance of Speed Control in Fog Machines

Speed control is essential in fog machines as it allows users to adjust the rate of fog output, which can significantly impact the overall effect. In scenarios such as theatrical productions, having the ability to fine-tune the density and flow of the fog can enhance dramatic moments and create a captivating visual experience. Similarly, at events like Halloween parties or weddings, the right amount of fog can set the mood and impress guests. For instance, a friend of mine once used a fog machine during a Halloween party, and by controlling the speed, he was able to create an eerie atmosphere that perfectly complemented the spooky decorations. Without speed control, the fog might have overwhelmed the space or fallen flat, but his careful adjustments made all the difference.

Features to Look for in a Fog Machine with Speed Control

When shopping for a fog machine with speed control options, there are several features to consider. Look for machines that offer adjustable output settings, which allow you to customize the fog's density to suit your needs. Remote control options can also be beneficial, providing the freedom to operate the machine from a distance without manually adjusting it. Other important features include heating elements that help with consistent fog production and tank capacity that determines how long you can run the machine before needing a refill. Depending on your intended use—whether for home parties or professional events—these features can significantly enhance your fog machine's performance.

How to Choose the Right Fog Machine for Your Needs

Choosing the right fog machine involves assessing your specific requirements. Consider the size of the space where you'll be using the machine; larger venues may require more powerful machines with higher output capacities. Additionally, think about the type of events you plan to host. If you're organizing a series of gatherings, investing in a high-quality fog machine with versatile speed control options will be worthwhile. Evaluating different models and reading user reviews can provide insight into their performance and reliability. Friends who have purchased fog machines often emphasize the importance of speed control, noting that it allows for greater creativity in how they use fog to enhance their events.

Elevating Your Event Atmosphere with Fog Machines

In summary, a fog machine with speed control options offers unparalleled flexibility for creating the perfect atmosphere for any event. The ability to adjust fog output can dramatically enhance the effects you want to achieve, whether it's for a theatrical performance, a themed party, or a photography session. As you consider your purchase, think about your specific needs and preferences to ensure you select a fog machine that aligns with your vision. With the right fog machine, you can truly elevate your events and create memorable experiences that linger in the minds of your guests.